

**NATIONAL INSTITUTE OF TECHNOLOGY MEGHALAYA**  
(An Institute of National Importance under Ministry of HRD, Govt. of India)  
Bijni Complex, Laitumkrah, Shillong-793003, Meghalaya.  
Ph:+91-364-2501169(O), Fax:+91-364-2501113  
Website:www.nitm.ac.in



## **TENDER DOCUMENT FOR**

### **THE WORK ():-**

**‘Extension of Scholar Research Room located at Deans’ Block Basement Floor near DIC for Laboratory Room of a Twin Cylinder CRDi, Turbocharged, Automative Dual Fuel Research Engine Test under Mechanical Engg. Deptt. of NIT Meghalaya at Bijini Complex, Laitumkrah,Shillong**

**February- 2021**

Signature of the Contractor:\_\_\_\_\_



**राष्ट्रीय प्रौद्योगिकी संस्थान मेघालय**  
**NATIONAL INSTITUTE OF TECHNOLOGY MEGHALAYA**  
(An Institute of National Importance under Ministry of HRD, Govt. of India)  
Bijni Complex, Laitumkhrah, Shillong-793003, Meghalaya.  
Ph: +91-364-2501294 (O) Fax: +91-364-2501113  
**Website: www.nitm.ac.in**

**NIT No: NITMGH/EN/TENDERS/03/2020-21/61**

**Dated: 12/02/2021**

1. On behalf of National Institute of Technology (NIT) Meghalaya, sealed item-rate tenders in single bid system are invited for the following work:

Sl/No	Description	Details
i.	Title of Work	'Extension of Scholar Research Room located at Deans' Block Basement Floor near DIC for Laboratory Room of a Twin Cylinder CRDi, Turbocharged, Automative Dual Fuel Research Engine Test under Mechanical Engg. Deptt. of NIT Meghalaya at Bijni Complex, Laitumkhrah, Shillong '
ii.	Estimated cost	Rs.1.45 lakh.
iii.	Period of completion	21(Twenty One) days.
iv.	Issue of tender document	The tender documents can be downloaded from the Institute website: <a href="http://www.nitmeghalaya.in">www.nitmeghalaya.in</a>
v.	Last date and time for receipt of tenders	18.02.2021 up to 13:00 hours
vi.	Due date and time of opening of tenders	18.02.2021 at 14:00 hours
vii.	Earnest Money Deposit (EMD)	Rs. 2900/-

**2. Eligibility Criteria:**

Tenderers should satisfy/fulfill the following eligibility criteria:

Sl.No.	Eligibility Criteria	Documentary proof for eligibility(Attested copies to be submitted)
a	Should have satisfactorily completed the works as mentioned below during the last seven years: i. Three similar works each costing not less than 40% of the estimated amount put to tender (or) ii. Two similar works each costing not less than 60% of the estimated amount put to tender (or) iii. One similar works costing not less than 80% of the estimated amount put to tender.	(i). Certified copy of work orders <b>and</b> completion certificates issued by the authority concerned (from client) clearly indicating the nature/scope of work, actual completion cost and actual date of completion for such work must be submitted to establish work experience. (ii). Completion certificates for works issued by Private parties shall be supported by Tax Deducted at Source (TDS) certificates.
<b>.Note: Similar works means Civil Works.</b>		

3. The tenderer shall submit along with the tender attested copies of the following documents : (i) Valid registration certificate with any Central/State/Public Sector Organisation. (ii) Labour Licence from the competent authority. (iii) Valid Tax clearance certificate. (iv) GST Registration Certificate (v) Income Tax Certificate for non-tribal contractors. (vi) KHADC Professional Tax Clearance Certificate (vii) Sales Tax Certificate if applicable (viii) PAN Card. (ix) TIN/TAN. (x) Nationality Certificate. (xi) ST/SC certificate from competent authority for tribal contractors. (xii) Attested passport size photo of the tenderer (xiii) Elector's Photo Identity Card (EPIC).

4. Non-Tribal contractors should produce/ furnish valid "Trading License" issued by the competent authority for undertaking work in Meghalaya as per the extant rules of statutory authority; without which tender shall be disqualified.

5. The contractor has to follow strictly the Government Labour Acts, which are in force at present and should ensure that all statutory labour laws and regulations are adhered to. All necessary arrangements for labour will have to be made by the contractor.

6. All rules and regulations relating to safety of the workers/ labourers should strictly be followed by the contractor.

7. The contractors engaging more than 5 (five) labourers from outside the State, should get themselves registered in the Labour Department.

8. Contractor should not employ labour or staff of doubtful integrity of the State. If anti-state or anti-social elements are employed by the contractor, his tender will be cancelled and no claim whatsoever will be entertained for any loss or damages.

9. No labours other than Indian Nationals shall be employed. The contractors are required to submit the list of labourers to the concerned Authority of the State if they are so demanded.
10. The contractor should register the labourers employed with the Meghalaya Building & Other Construction Workers' Welfare Board.
11. The documents furnished by the tenderers will be subjected to verification subsequently by the Institute. If found not meeting the requirement, such offers will be rejected.
12. On meeting the eligibility criteria specified in Para 2 above, tender documents can be downloaded from Institute Website: [www.nitmeghalava.in](http://www.nitmeghalava.in).
13. Tenders should be accompanied with Earnest Money Deposit for value specified in Para 1 above, in the form of Demand Draft/Banker's Cheque/Deposit at Call Receipt/Term Deposit Receipt of any Scheduled Bank issued in favour of National Institute of Technology Meghalaya payable in Shillong, (or) in the form of Bank Guarantee issued by a Scheduled Bank. Earnest Money Deposit shall be valid for **90 days** from the date of receipt of tenders.
14. Tenders should be submitted in two sealed covers as below:  
*Cover i.* Containing Earnest Money Deposit: This cover shall be super-scribed with 'Earnest Money Deposit and also the name of work, NIT number and name of the tenderer. Tenders without requisite EMD amount with full validity as specified in Para 13 (b) above shall summarily be rejected.  
*Cover ii.* Containing Tender documents: This cover shall be super-scribed with 'Tender documents' and also the name of work, NIT number and name of the tenderer. This cover shall contain the full set of downloaded tender documents prepared by the Institute duly filled in and signed along with credentials of the tenderer.
15. The tenderer shall quote rates in figures as well as in words eligibly and amount tendered by them. The amount for each item shall be worked out and requisite total amount given. All corrections shall be attested by the dated initials of the tenderer.
16. The rates inclusive of Tax, Labour Cess and other taxes as applicable shall be quoted and filled only on the price format /schedule of quantities) furnished along with the tender document.
17. The tenderer shall not detach any page from the tender documents serially numbered. If any page is detached and not arranged as per serial no., the tender shall be rejected.
18. All the two covers mentioned above shall be put in another sealed cloth lined cover super-scribing the name of work, NIT number and Name of the tenderer.
19. Rates quoted by the contractor in figures and words shall be accurately filled in so that there is no discrepancy in the rates written in figures and words. However, if a discrepancy is found the rates which correspond with the amount worked out by the Contractor shall be taken as correct.
20. If the amount of an item is not worked out by the Contractor or it does not correspond with the rate written either in figures or words, then the rate quoted by the Contractor in words shall be taken as correct.
21. Where the rates quoted by the Contractor in figures and in words tally but the amount is not worked out correctly the rate quoted by the Contractor will be taken as correct and not the amount.
22. In the event no rate has been quoted for any item(s), leaving space both in figure(s), word(s) and amount in blank, it will be presumed that the contractor has included the cost of this/these item(s) in other items and rate for such item(s) will be considered as zero and work will be required to be executed accordingly.
23. In the event of responsive parties quoting same rates, the Institute will have the right to decide on the allotment of work to any of the responsive party/ parties without assigning any reasons thereof.
24. The rates quoted for all items should be finished in workman like manner inclusive of all leads, lifts and incidental charges/expenditure **including minor repairs such as cracks/ fissures, etc of walls, etc..** No extra payment is admissible on account of these.
25. Rates once quoted shall be firm, fixed, un-revisable and binding on the contractor. Variation upto 10% may be allowed for peculiar situation and special circumstances. Tenders above or below this limit will not be accepted.
26. Tenderers shall sign all the pages of the tender documents. The tender document, duly filled in at required pages, along with drawings (if supplied) should be returned along with the tender.
27. Intending tenderers may inspect the site before submitting the tenders, with the prior permission of Authority of the Institute.
28. The contractors should arrange all the machineries, tools & plants required for the work by themselves.
29. Contractors should have their own Technical Supervisor/Site Engineer at site.
30. Materials required for the works shall be procured by Contractors from their own resources. All the materials are to be got approved by Engineer-in-Charge before incorporating in the work
31. The contractor has to make own arrangement for the use of electricity and water for the purpose/work and nothing extra will be paid for the same.
32. The work shall be done strictly as per plans/drawings and specifications approved by NIT Meghalaya. The wordings "as per specifications" shall mean specifications for Civil works & PH works of CPWD/State PWD Specifications or ISI/IRC specifications in the same order of precedence. In the absence of particular specifications for the item of work in any one of the documents mentioned, the decision of Engineer-in-charge is final.

33. Quality control tests during execution of work, as recommended by relevant IS Code & as per direction of Engineer in charge, shall be done by the Contractor at his /her own cost. Besides, one or more original receipts of purchase of Steel, cement etc. (conforming to ISI ) from the authorized dealers of such materials are to be submitted to the Engineer in- charge, if applicable, on procurement of such materials, **if asked for by the NIT Meghalaya.**
34. The specifications & make of individual items as per Schedule of quantities is for reference and to be followed under normal circumstances. However, products of equivalent range, quality and make may be allowed with approval by the Engineer-in-charge.
35. During execution of the works, the contractor shall keep the site reasonably free from all unnecessary obstructions. All equipments/ materials shall be kept/ stored properly in consultation with the Engineer-in-Charge. The contractor should remove and clear all surplus materials, trashes, temporary works, etc. from the construction site and surrounding area after completion of the work and before handing over the work to NIT Meghalaya to the satisfaction of the Director or his authorized representative.; failing which 'completion certificate' will not be issued.
36. The time period of completion of work shall be in accordance with the time schedule indicated in the tender notice from the date of issue of work order. The period includes monsoon periods also.
37. In case the contractor fails to complete the work within the stipulated time mentioned in the work order, then action shall be taken against such contractor at the discretion of the NIT Meghalaya authority which may lead to debar him from further tendering in the NIT Meghalaya.
38. The rate of compensation for delay in completion of work is 0.5% per week to be computed on per day basis subject to a maximum of 10% of the tendered/quoted value of work.
39. The method of measurement for payment against work done under the various items of "Schedule of Quantities" shall be regulated as per prevailing Indian Standards published by Bureau of Indian standards. However, as regards the applicability of the item rates for the work done, the decision of Engineer-in-Charge shall be final and binding.
40. In the "Item of work/Description of work" column, "Unit" column and "Quantity" column, the various abbreviations, shall mean as below:
- M/m/Rm/Mtr/mTR/MTR shall mean "Metre" in length or breath or Depth.
  - SQM/Sqm/SM/m<sup>2</sup>/Sm/M<sup>2</sup> shall mean "Square Metre" in area.
  - Cu.m/cu.m/CUM/CuM/m<sup>3</sup>/M<sup>3</sup> shall mean "Cubic Metre" in volume
  - Kg/kg/KG shall mean "Kilogram" in weight.
  - MT/mT/Mt/T shall mean "Metric tonne" in weight
  - cm/Cm/CM shall mean "Centi-metre"
  - mm/MM/mM/Mm shall mean "Milli-metre"
  - PT/Pt/pt/pT shall mean one "Point" in wiring works.
41. The contractor/firm shall have to give a declaration to the effect that he/they do hereby declare that he/they have thoroughly acquainted himself/themselves with all the clauses contained in the detailed notice inviting tenders and agree to the terms and conditions stipulated there in.
42. Tenders will be received and opened at the office of Executive Engineer, NIT Meghalaya, Shillong on the stipulated date and time stipulated in Para 1 above. Delayed and late tenders will summarily be rejected. Tenders will be opened in the presence of intending tenderers or their authorized representatives if any.
43. On the due date of opening, the cover (i) will be opened initially. Subsequently, on the same day cover (ii) of those tenderers who furnished valid EMD only will be opened. On opening of cover (ii) further detailed scrutiny/evaluation will be carried out. During the evaluation of the bids, the documents furnished by the tenderers will be scrutinized in detail. Any tender found as not fulfilling the eligibility criteria will be rejected and such offers will not be considered for further processing. At this stage, the competency of the tenderers will be further evaluated by the Tender Evaluation Committee. The price bids of only those tenderers who have fulfilled NIT/eligibility criteria will be considered.
44. Security deposit @ 10% of the value of work shall be deducted from the bill and to be released after completion of defect liability period **OR** The successful bidder may submit Performance Bank Guarantee @ 10% of value of work in the form of Deposit at Call Receipt/Term Deposit Receipt of any Scheduled Bank issued in favour of NIT Meghalaya, Shillong to be released after completion of defect liability period.
45. The successful tenderer (s) on receipt of work order shall register themselves with the Labour Commissioner/Labour Department, Govt. of Meghalaya for Building and other Construction Workers (Regulation of Employment and Conditions of Service Act, 1996) and a certificate should be produced; without which their bills will not be processed.
46. The successful contractor (s) on receipt of work order shall obtain a Labour License from the District Labour Officer/Labour Department issued specifically for undertaking work(s) in National Institute of Technology Meghalaya.
47. When whole of the work have been substantially completed, the contractor shall give a notice to the Engineer-in-Charge accompanied by a written undertaking to finish with due expedition any outstanding work during the defect liability period. Such notice and undertaking shall be deemed to be a request by the contractor to the Engineer-in-Charge to issue a taking over certificate.
48. Defect Liability Period shall be 06 (six) months calculated from the date of completion of the work certified by the Engineer-in-Charge in the completion certificate.

49. Payments can be made to the contractor after successful completion of the work with due certification and satisfaction of the Engineer –in-Charge.
50. Security Deposit of 10 %( ten percent) shall be deducted from the bills of the contractor and shall be released after expiry of the defect liability period.
51. GST as applicable shall be deposited by the contractor to the respective concerned authority.
52. Labour Cess, etc. as applicable shall be deducted from the bills of the contractor.
53. NIT Meghalaya is not bound to accept the lowest or any other tender and reserves the authority to reject any or all the tenders received without assigning any reason.
54. All tenders in which any of the prescribed condition is not fulfilled or any condition including that of conditional rebate is put forth by the tenderer shall be summarily rejected.
55. Notwithstanding the various conditions prescribed in the Tender document, the NIT Meghalaya may relax one or more such conditions, if required, in favour of deserving tenderer, in the interest of the NIT Meghalaya, without compromising with the quality & standard so required for implementation of the work.
56. NIT Meghalaya also reserves the right to alter the scope/ or reduce the quantum of work before/ after issue of work order and the tenderer shall not have any claim what so ever on this account.
57. NIT Meghalaya reserves the right of accepting the whole or any part of the tender and the tenderer shall be bound to perform the same at the rate quoted.
58. Canvassing directly or indirectly in connection with tender is strictly prohibited and the tenders submitted by the contractors who resort to canvassing will be liable for rejection.
59. NIT Meghalaya reserves the option to give preferences to the offers in accordance with the policies of the Government from time to time.
60. The contractor shall not be permitted to tender for works in the Institute if his/her relative is working. He/she shall also intimate the names of persons who are working with him/her in any capacity or are subsequently employed by him/her and who are near relatives to any Gazetted Officer in the Institute. Any breach of this condition by the contractor would render him/her liable for rejection of tender or cancellation of contract.
61. The tender should be valid for **minimum period of 90 days** from the due date of receipt of the tender specified in Para 1 above. If any tenderer withdraws the offer within the validity period or makes any modifications in the terms and conditions of the tender which are not acceptable to the Institute, the Government shall without prejudice to any other right or remedy, be at liberty to forfeit 50%(fifty percent) of the Earnest Money Deposit absolutely. Further, the tenderer shall not be allowed to participate in the re-tendering process of the work.
62. Arbitration: Disputes, if any, shall be settled mutually; failing which, it shall be referred to a One- Man Arbitrator to be appointed by Director, NIT Meghalaya in accordance with the Arbitration and Conciliation Act 1966, whose decision shall be final and binding on both the parties.
63. The acceptance of the tender will rest with the Director, NIT Meghalaya who does not bind himself to accept the lowest or any other tender. No reasons will be furnished for the acceptance or rejection of any tender.
64. On concluding the tendering process, an agreement shall be drawn with the successful tenderer on non-judicial stamp paper of adequate /required value consisting of: The Notice Inviting Tender, all the documents including all conditions, specifications and drawings, if any, forming the tender as issued at the time of invitation of tender and acceptance thereof together with any correspondence leading thereto.
65. NIT Meghalaya reserves the right to accept or reject any tender without assigning any reason (s) thereof.

**Sd/-**  
**Executive Engineer**  
**NIT Meghalaya**

**SCHEDULE OF QUANTITIES**

**Name of work: Extension of Scholar Research Room located at Deans' Block Basement Floor near DIC for Laboratory Room of a Twin Cylinder CRDi, Turbocharged, Auto mative Dual Fuel Research Engine Test under Mechanical Engg. Deptt. of NIT Meghalaya at Bijini Complex, Laitumkhrach, Shillong .**

The estimated Rate as per Meghalaya PWD SOR (Building) for 2015-16 for Khasi Hills Region

Sl. No	Particulars of Works	Qty	Units	Rates to be quoted in figures & words and shall be inclusive of all taxes (Rs)	Amount. (Rs)
1	Earthwork in excavation upto a depth of 2m below the existing ground level for foundation trenches of foundations, footings of column/ walls, retaining walls, septic tank etc.....as directed and specified for the following classification of soils.	4.57	Cum		
2	Providing brick soling in foundation and under floor with stone.....as directed including all labour and materials and if necessary dewatering, complete. Stone soling of thickness 100mm.	21.28	Sqm		
3	Supplying, fitting and fixing in position reinforcement bars upto 1st floor level, conforming to relevant I.S. Code .....complete. (Rates inclusive of all wastage, lappage, hooks, chairs, anchorage etc. and no measurements for the same is required) ISI approved Mild steel reinforcement bar (M.S. Bar)	0.389	Qntl		
4	65 mm thick cement concrete floor consisting of 50 mm under layer of cement concrete in prop. 1:3:6 ..... finished with a floating coat of neat cement finish (using cement slurry for bond @ 2.75 kg. per square metre of floor area) including curing etc. complete as directed.	21.28	Sqm		
5	Providing 100 mm thick hollow cement concrete block wall of cement mortar in proportion 1:1:8 .....curing 3(three) times a day for ten days in super structure above plinth upto 1st floor	28.99	Sqm		
6	Providing form work of ordinary timber planking of thickness not less than 25mm and removal of the same for concrete members.....as specified for the following items: Sides and Soffits of Beams, beam haunchings, cantilever girders, bressumers, lintels and horizontal ties. For depth not exceeding 1.0M.	3.78	Sqm		

7	Providing and laying Concrete in Reinforced Cement Concrete Works using Concrete Mixture Machine with coarse sand & 20mm down graded stone aggregate including dewatering if necessary, and curing complete .....(form work and reinforcement will be measured and paid separately)	0.22	Cum		
	In Columns, pillars, posts ...lintel, sill band, beam, .....etc. above plinth level upto 1st floor level. (Without using admixture, plasticiser)				
	M15 or Prop. 1:2:4 (For Non-structural Works)				
8	Providing, fitting and fixing steel windows/ ventilators (openable) of standard rolled steel sections as per relevant I.S. Code- 1038 joints mitred and welded with 15mmx3mmx100mm lugs ..... complete as per drawing including applying a priming coat of red-lead paint.	2.40	Sqm		
9	Providing and fixing clear sheet glass bedded in putty and fixed with/without wooden beading including necessary cutting of glass to the required size (payment for wooden bead shall be made separately)	2.40	Sqm		
	4.00mm thick (Area of glass panes exceeding 400 sq.cm but less than 1200 sq.cm.)				
10	Providing wood work in frame (chowkats) of doors, windows, clerestory windows and other similar works wrought, framed and fixed in position in contact with C.C or brick masonry wall ..... as directed and specified	0.04	Cum		
	White pine				
11	Providing, fitting and fixing full panelled doors/ windows including oxidised M.S butt hinges (100mm x 75 mm x 3.55mm) with necessary screws (other fittings to be measured and paid separately)	2.00	Sqm		
	With White pinewood				
	30 mm thick.				
12	15 mm thick Cement plaster in single coat on rough side of single or half brick wall for interior plastering up to 1st floor level including arises, internal rounded angles, not exceeding 80mm girth and finished even and smooth including curing complete as directed	57.98	Sqm		
	In cement mortar 1:4				

13	Providing undressed woodwork in roof truss, rafter, purlin, tie and the like including hoisting and fixing in position with necessary spikes, nails including M.S straps with bolt and nuts etc. complete ..... angle cleats wherever used shall be measured and paid separately).	0.437	Cum				
	With White pinewood/ 2nd class treated timber						
14	Providing corrugated galvanised Iron sheet roofing of TATA SHAKTEE / SAIL including fitting and fixing necessary galvanised J or L hooks, bolts and nuts 8 mm dia with bitumen washer 25 mm dia x 3 mm thick and 1.6 mm thick limpet washer complete excluding cost of roof truss, purlin etc. (Roof trusses and purlin etc.to be measured and paid separately).	27.00	Sqm				
	0.45 mm thick						
15	Supplying, fitting, fixing anodised aluminium fittings of approved make, reasonably smooth, free from sharp edges and corners, flaws .....etc. complete. (anodised to bright natural matt & satin finished)						
	Sliding Door Bolt					1	Each
	250mm x 16mm						
	Tower Bolt					2	Each
	200mm x 12mm						
	Door Handle					1	Each
100mm							
16	Distemping two coats with oil bound distemper of approved brand and manufacture and of required shade on new wall surface to give an even shade, over and including a priming coat with distemper primer ..... preparing surface even and sand papered smooth.						
	Priming coat with distemper primer					57.98	Sqm
	Top coat					57.98	Sqm



17	Applying priming coat over new wood and wood based surfaces over 100mm in girth/width after and including preparing the surface by thoroughly cleaning oil, grease, dirt and other foreign matter, sand papering and knotting	5.20	Sqm		
	With ready mixed paint , Wood primer (pink/ white)				
18	Painting two coats (excluding priming coat) on new wood and wood based surface with enamel paint ..... cleaning the surfaces of all dirt, dust and other foreign matter sand papering and stopping.	5.20	Sqm		
	Surfaces over 100mm in width or girth.				
	General purpose (Asian paint/ Berger paint/ ICI paint/ J & N paint/ Nerolac).				
19	Painting two coats (excluding priming coat) on new steel and other metal surface with enamel paint ..... cleaning the surface of all dirt, dust and other foreign matter.	1.60	Sqm		
	Surfaces over 100mm in width or girth.				
	General purpose (Asian paint/ Berger paint/ ICI paint/ J & N paint/ Nerolac).				
20	Supplying, fitting and fixing chain link fencing of 10 S.W.G, G.I. Wire 50mmx50mm mesh fitted to M.S angle iron post..... fencing tight and erect complete, including one coat of primer painting to M.S angle iron post in P.C.C base etc. with following.	5.76	Sqm		
	Corner and end posts with M.S angle of size 50mmx50mmx 5mm .....two numbers as stayposts.				
21	Supplying fitting and fixing G.I. Pipes(TATA/ SAIL/ NEZONE and their equivalent) with all necessary 'R' brand or similar approved G.I. Fittings such as bend, tee, elbow, .....directed and specified	15.00	Rm		
	Exposed on wall				
	25 mm dia				
22	Supplying and fitting ball valve as specified and directed.	1.00	Each		
	25 mm dia. (gun metal)				

*Dated Signature of Tenderer's with Seal*

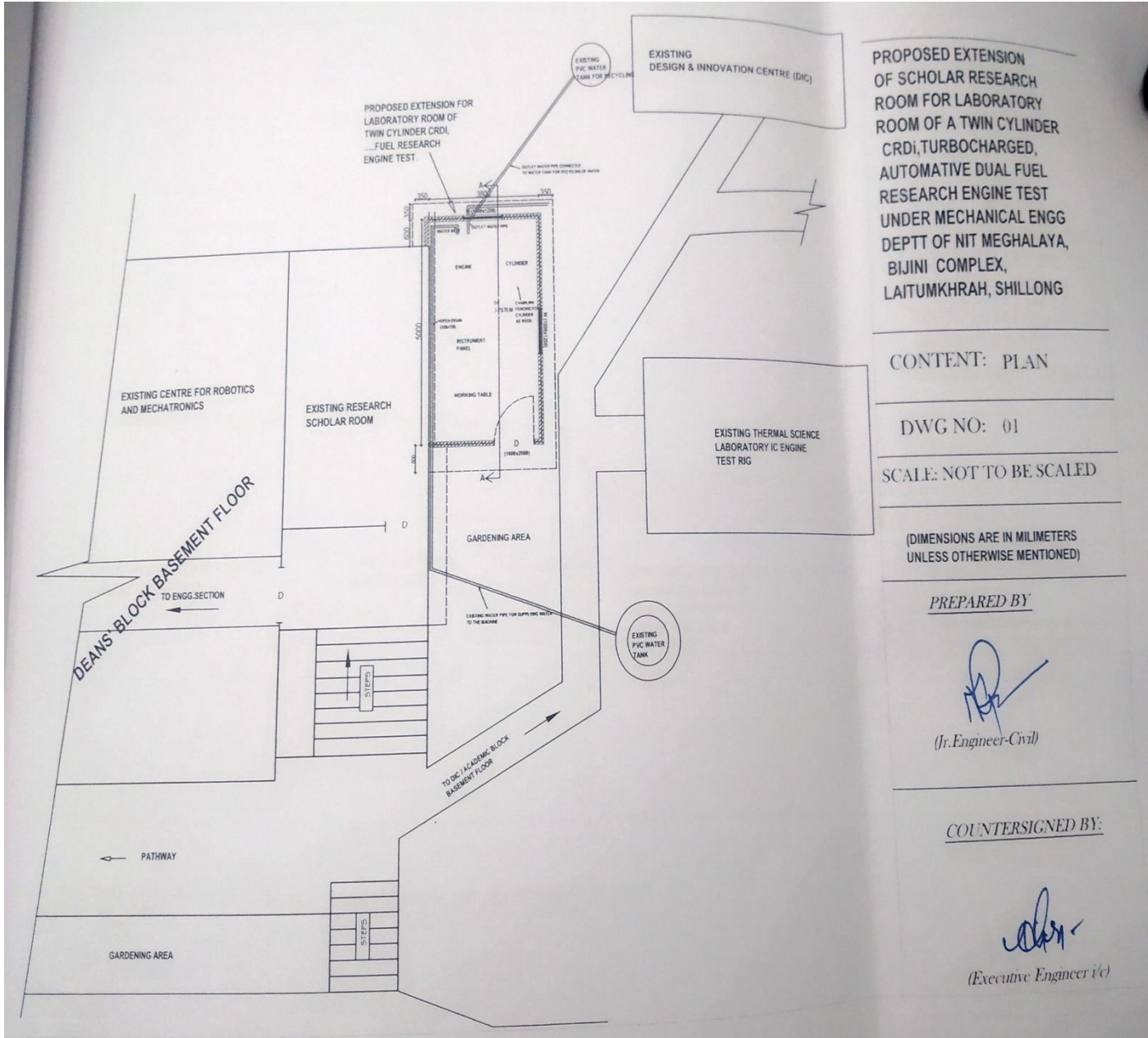

PROPOSED EXTENSION OF SCHOLAR RESEARCH ROOM FOR LABORATORY ROOM OF A TWIN CYLINDER CRDI, TURBOCHARGED, AUTOMOTIVE DUAL FUEL RESEARCH ENGINE TEST UNDER MECHANICAL ENGG DEPTT OF NIT MEGHALAYA, BIJINI COMPLEX, LAITUMKHRAH, SHILLONG

CONTENT: PLAN

DWG NO: 01

SCALE: NOT TO BE SCALED

(DIMENSIONS ARE IN MILLIMETERS UNLESS OTHERWISE MENTIONED)

PREPARED BY

*(Signature)*  
(Jr. Engineer-Civil)

COUNTERSIGNED BY:

*(Signature)*  
(Executive Engineer i/c)

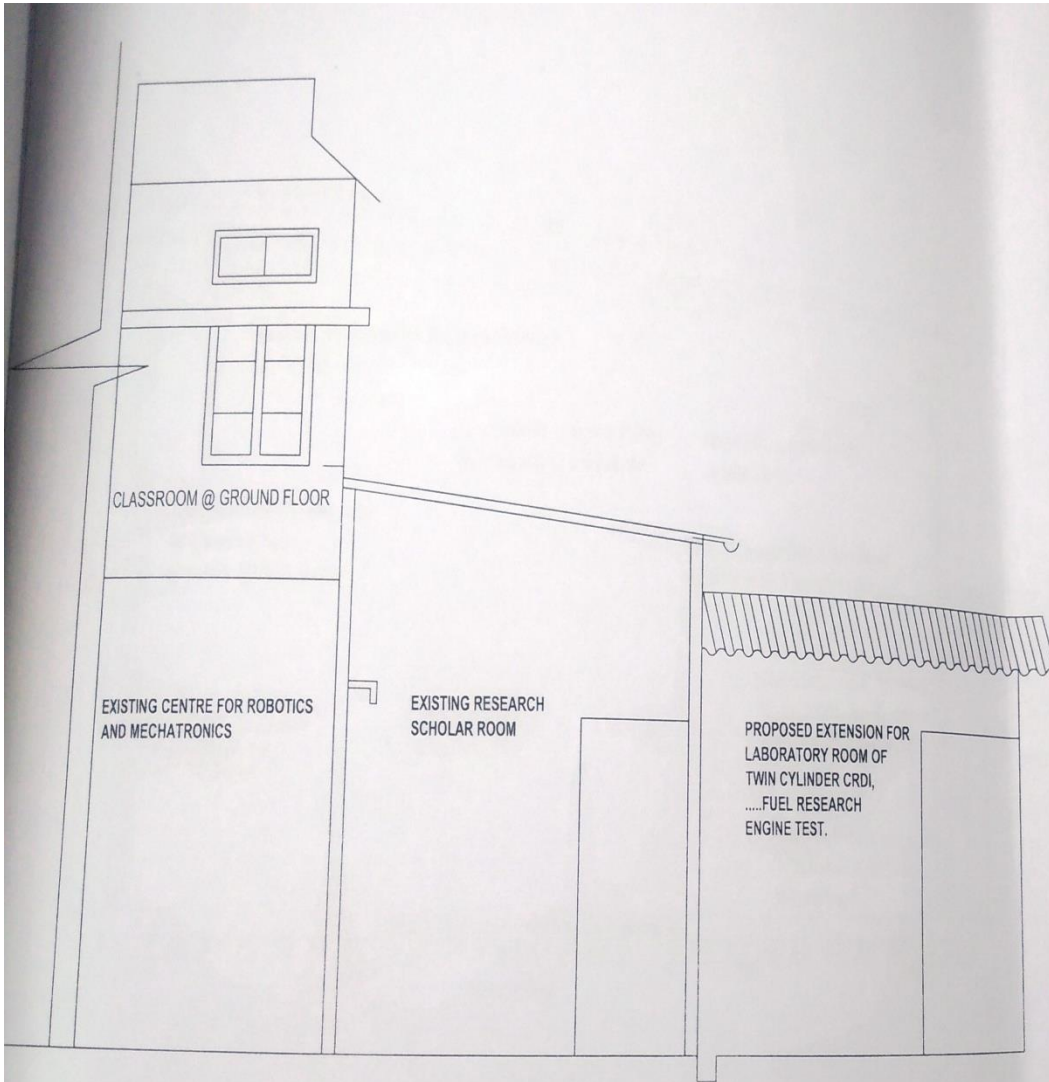

PROPOSED EXTENSION  
 OF SCHOLAR RESEARCH  
 ROOM FOR LABORATORY  
 ROOM OF A TWIN  
 CYLINDER CRDI,  
 TURBOCHARGED,  
 AUTOMATIVE DUAL FUEL  
 RESEARCH ENGINE TEST  
 UNDER MECHANICAL ENGG  
 DEPTT OF NIT MEGHALAYA,  
 BIJINI COMPLEX,  
 LAITUMKHAH, SHILLONG

CONTENT:  
 ELEVATION

DWG NO: 02

SCALE: NOT TO BE SCALED

(DIMENSIONS ARE IN MILLIMETERS  
 UNLESS OTHERWISE MENTIONED)

PREPARED BY

  
 (fr. Engineer-Civil)

COUNTERSIGNED BY:

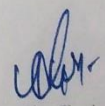
  
 (Executive Engineer i/c)

N.B: DIMENSIONS ARE IN MM UNLESS  
 OTHERWISE MENTIONED

FRONT ELEVATION OF PROPOSED ROOM

PROPOSED EXTENSION  
 OF SCHOLAR RESEARCH  
 ROOM FOR LABORATORY  
 ROOM OF A TWIN  
 CYLINDER CRDi,  
 TURBOCHARGED,  
 AUTOMATIVE DUAL FUEL  
 RESEARCH ENGINE TEST  
 UNDER MECHANICAL ENGG  
 DEPTT OF NIT MEGHALAYA,  
 BIJINI COMPLEX,  
 LAITUMKHAH, SHILLONG

CONTENT:  
 SECTION AT A-A

DWG NO: 03

SCALE: NOT TO BE SCALED

(DIMENSIONS ARE IN MILLIMETERS  
 UNLESS OTHERWISE MENTIONED)

PREPARED BY

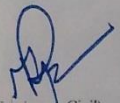
  
 (Jr. Engineer Civil)

COUNTERSIGNED BY:

  
 (Executive Engineer i/c)

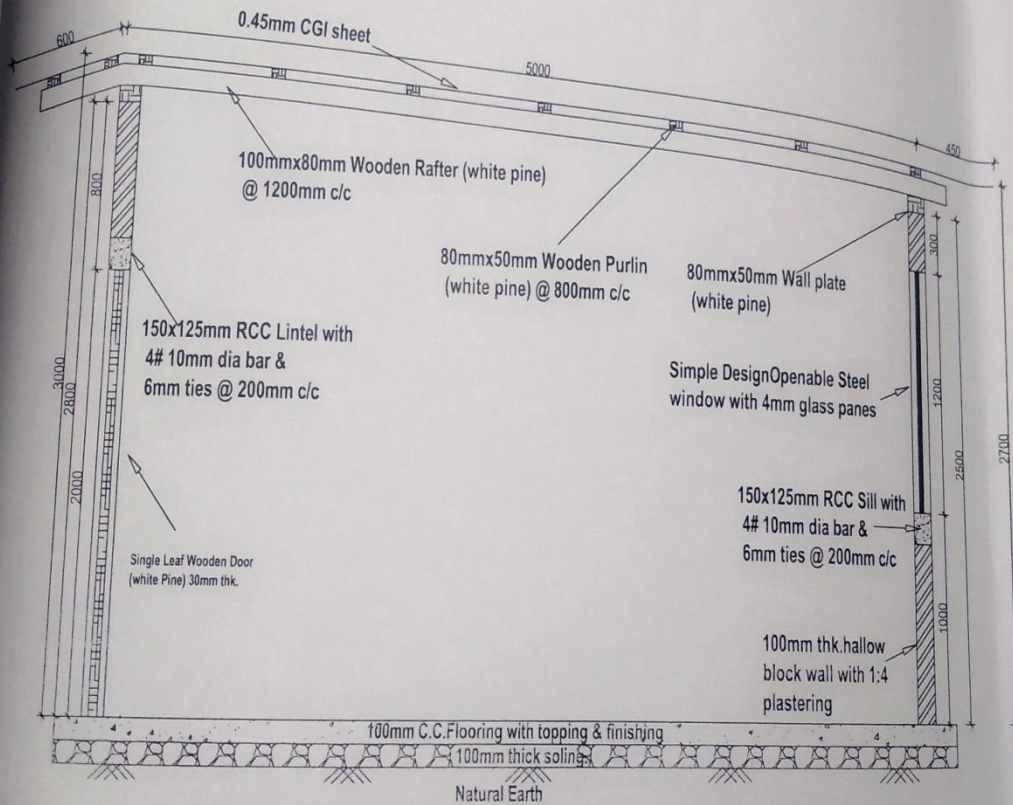

## UNDERTAKING IN FORM - A

*I do hereby declare that the works will be done by me and I also hereby declare that the signature in all pages of the tender papers is signed by me.*

*Further, I declare that I have gone through the various clauses of the contract document and I am fully conversant with all the clauses contained therein and agree to abide by the same.*

*Full Name of contractor* : \_\_\_\_\_

: \_\_\_\_\_

*Full Address (Present)* : \_\_\_\_\_

: \_\_\_\_\_

: \_\_\_\_\_

*Full Address (Permanent):* \_\_\_\_\_

: \_\_\_\_\_

: \_\_\_\_\_

*Contact Number* : \_\_\_\_\_

*E-mail ID* : \_\_\_\_\_

*Registration No.* : \_\_\_\_\_

**(Signature of the Tenderer's with seal)**