

**राष्ट्रीय प्रौद्योगिकी संस्थान मेघालय**  
**NATIONAL INSTITUTE OF TECHNOLOGY MEGHALAYA**  
(An Institute of National Importance under Ministry of Education, Govt. of India)  
Permanent Campus, Saitsohpen, Sohra-793108, Meghalaya.  
Ph: +91-364-2501169(O), Fax: +91-364-2501113  
Website: www.nitm.ac.in



**TENDER DOCUMENT FOR**

**THE WORK :-**

**“Construction of IC Engine Room & Net fencing for Solar behind Central Workshop at NIT  
Meghalaya Permanent Campus, Saitsohpen, Sohra”**

**August- 2025**

**Signature of the Contractor:\_\_\_\_\_**

**To:**

**The Executive Engineer  
National Institute of Technology Meghalaya  
Saitsohpen, Sohra, East Khasi Hills District, Meghalaya  
Pin code-793108**

**Sub:** Submission of Tender.

**Name of Work:** \_\_\_\_\_

**Ref:** Tender Notice No. \_\_\_\_\_

Sir,

I/We have the honour to submit herewith the tender for the above mentioned work.

I/We am/are registered class \_\_\_\_\_ ( ) contractor of \_\_\_\_\_.

I/We have gone through the detailed tender document and agree to execute the work if allotted to me/us as per the terms and condition laid down therein and at the quoted rates by me/us in Annexure-I.

I/We do hereby agree to abide by all the terms and conditions laid there in and if the work is allotted to me/us, the same will be executed as per specifications/drawings, terms & conditions of contract agreement.

Earnest money amounting to ₹. \_\_\_\_\_ in the form of banker's cheque/crossed demand draft No. \_\_\_\_\_ Dated \_\_\_\_\_ is enclosed.

The tender document in original and attested copies of the certificates/credentials, etc. and passport size photograph are enclosed herewith for your consideration

I /We therefore seal and sign the tender paper and return them duly filled in original.

Yours faithfully,

Signature with date of the tenderer

Dated: \_\_\_\_\_

Name (in block letters): \_\_\_\_\_

Address \_\_\_\_\_

Phone No: \_\_\_\_\_

Regn. No: \_\_\_\_\_



**राष्ट्रीय प्रौद्योगिकी संस्थान मेघालय**  
**NATIONAL INSTITUTE OF TECHNOLOGY MEGHALAYA**  
 (An Institute of National Importance under MoE, Govt. of India)  
 Permanent Campus, Saitsohpen, Sohra-793108, Meghalaya.  
 Ph: +91-364-2501294 (O) Fax: +91-364-2501113  
 Website: [www.nitm.ac.in](http://www.nitm.ac.in)

**NIT No: NITMGH/EN/TENDER/60/2025-26/156**

**Dated: 14/08/2025**

1. On behalf of National Institute of Technology (NIT) Meghalaya, sealed item-rate limited tenders in single bid system are invited for the following work:

Sl/ No	Description	Details
i.	Title of Work	Construction of IC Engine Room & Net fencing for Solar behind Central Workshop at NIT Meghalaya Permanent Campus, Saitsohpen, Sohra
ii.	Approved Estimated Cost	Rs. 7,53,152/- ( <i>inclusive of 18% GST</i> )
iii.	Period of completion	21 (twenty one) days.
iv	Cost of tender document.	N/A
v	Date of Publishing	14.08.2025
vi	Bid Document Download Date	14.08.2025
vii	Bid Submission Start Date	14.08.2025
viii	Bid Submission End Date	27.08.2025 up to 13:00 hours
ix	Bid Opening Date	27.08.2025 at 15.00 hours onwards
x	EMD	Rs.15,000/-

**2. Eligibility Criteria:**

The agency shall fulfill the following conditions.

Sl.No.	Eligibility Criteria	Documentary proof for the eligibility (To be scanned & uploaded)
1.	Should have satisfactorily completed the works as mentioned below during the last five years. i. Three similar works each costing not less than 40% of the estimated cost (or) ii. Two similar works each costing not less than 60% of the estimated cost (or) iii. One similar work costing not less than 80%	i. Work orders and completion certificates issued by the authority concerned to establish work experience. ii. Completion certificates for works issued by private parties shall be supported by TDS (Tax Deducted at Source) certificates.
	<b>Note:</b> Similar work shall mean <u>Execution of Civil works.</u>	

## **TERMS & CONDITIONS**

1. All the mandatory documents required for construction works; viz; Registration Certificate, GST Registration, Valid Tax Clearance Certificate, KHADC Professional tax, PAN Card, Adhaar, EPIC, EPF/ESI, Labour License, ST Certificate, Trading License (as applicable), etc. are to be submitted along with the tender; failing which tender(s) will summarily be rejected.
2. Contractor shall follow all laws, regulations and acts of Central/ State Government and other statutory bodies relating to engaging of labourers in work, wages and all related provisions and indemnify Government/Institute against payment to be made under and for the observance of the said labour laws.
3. The tender(s) shall be put under envelop super-scribing the name of work, NIT No. and Name of the Bidder. Tenders should contain full set of downloaded tender documents duly filled in and signed along with credentials of the tenderer.
4. Tenders should be accompanied with Earnest Money Deposit for value specified in Para 1 above, in the form of Demand Draft/Deposit at Call receipt/ Term Deposit Receipt of any Scheduled Bank issued in favour of **Director, NIT Meghalaya** (or) in the form of Bank Guarantee issued by a scheduled bank. Earnest Money Deposit shall be valid for **180 days** from the due date of receipt of tenders. EMD is exempted for MSME's.
5. Rates shall be quoted in figures as well as in words. The rate quoted for each item should be inclusive of applicable GST rate/ taxes. The amount for each item shall be worked out and requisite total amount given. All corrections shall be attested by the dated initials of the bidder.
6. Rates once quoted shall be firm, fixed, un-revisable and binding on the contractor. Variation upto (+) or (-) 10% may be allowed for peculiar situation and special circumstances. Tenders above/below this limit will not be accepted. The rates quoted for all items should be finished in workman like manner inclusive of all leads, lifts and incidental charges/expenditure including minor repairs such as cracks/ fissures, etc of walls, etc.. No extra payment is admissible on account of these.
7. The contractors should arrange all the machineries, tools & plants required for the work by themselves.
8. The work should be carried as per specifications mentioned for each items in the SOQ and up to the desired level as per direction of the Engineer- In-charge.
9. The time period of completion of work shall be in accordance with the time schedule indicated in the NIT from the date of issue of work order.
10. Bill to be claimed only after successfully completion of the work in all respects as per requirements.
11. Security deposit @ 10% of the value of work shall be deducted from the bill and to be released after completion of defect liability period.
12. Defect Liability Period shall be 06 (six) months calculated from the date of completion of the work certified by the Engineer-in-Charge in the completion certificate. If any defects occurs within three months after the completion of the work rectification/repairing of the same should be done by the contractor at his/her own cost.
13. Labour Cess, etc. & Forest royalty as applicable shall be deducted from the bills of the contractor
14. The acceptance of the tender will rest with the Director, NIT Meghalaya who does not bind himself to accept the lowest or any other tender. No reasons will be furnished for the acceptance or rejection of any tender. NIT Meghalaya reserves the right to accept or reject any tender or cancelled the same without assigning any reason (s) thereof.

**Sd/-**  
**Executive Engineer**  
**NIT Meghalaya**

Name of the Work: Making of IC Engine room & Net Fencing for Solar behind Central Workshop at NIT Meghalaya Permanent Campus, Saitsohpen, Sohra

Schedule of Quantities

Sl.No	Description of Items	Qty.	Unit	Rates to be quoted in figures and words i/c of GST/taxes etc (Rs.)	Amount (Rs.)
1	Earthwork in excavation by manual means up to a depth of 2m below the existing ground level for foundation trenches of foundations, footings of column/ walls, retaining walls, septic tank etc. including bailing out water where necessary and removal Of surplus earth with all lead and lifts as directed and specified for the following classification of soils.	1.40	Cum		
	In hard rock				
	Blasting prohibited				
2	Random rubble masonry with hard stone in foundation and plinth including levelling up with cement concrete 1:6:12 (1 cement: 6 coarse sand: 12 graded stone aggregate 20 mm nominal size) up to plinth level with:	4.53	Cum		
	Cement mortar 1 :6 (1 cement: 6 coarse sand)				
3	Centering and shuttering including strutting, propping etc. and removal of form for all heights complete and as directed by Engineer in charge.	10.06	Sqm		
	Walls (any thickness) including attached pilasters, buttresses, plinth and string courses etc (using steel)				
4	Providing soling with stone/ best quality picked jhama brick, sand packed and laid to level and in panel after preparing the subgrade as directed including all labour and materials and if necessary dewatering, complete.	104.05	Sqm		
	Stone soling				
	100 mm				
5	Plain cement concrete works in foundation bed for footing steps, walls, brick works etc below plinth level as directed and specified including dewatering if necessary, and curing complete (shuttering where necessary shall be measured and paid separately).	12.32	Cum		
	1 :3:6 (1 Cement: 3 coarse sand: 6 graded stone aggregate 20 mm nominal size)				
6	Half brick masonry with common burnt clay (non modular) 1st class bricks in superstructure above plinth level up to first floor level,	13.05	Sqm		
	Cement mortar 1 :4 (1 cement: 4 coarse sand)				

7	Structural steel work in single section, fixed with or without connecting plate, including cutting, hoisting, fixing in position and applying a priming coat of approved steel primer all complete.	1321.48	kg		
8	Supplying at site Angle iron post & strut of required size including bottom to be split and bent at right angle in opposite direction for 10 cm length and drilling holes up to 10 mm dia. etc. complete	79.78	kg		
9	Providing and fixing G.I. chain link fabric fencing Of required width in mesh size 50x50 mm including strengthening with 2 mm dia. wire or nuts, bolts and washers as required complete as per the direction of Engineer-in-charge	30.60	kg		
	Made of G.I. wire of dia. 4 mm				
10	Providing and fixing pre-coated galvanised iron profile sheets (size, shape and pitch Of corrugation as approved by Engineer-in-charge) 0.50 mm..... using selfdrilling/ self tapping screws of size (5.5x55 mm) with EPDM seal, complete up to any pitch in horizontal or vertical or curved surfaces, excluding the cost of purlins, rafters and trusses and including cutting to size and shape wherever required.	168.95	Sqm		
	Providing and fixing pre-coated galvanised steel sheet roofing accessories 0.50 mm..... using self-drilling/ selftapping screws complete:				
11	(I) Ridges plain (500-600mm)	9.12	Rm		
	(II) Gutter (600 mm over all girth)	8.62	Rm		
12	Providing and fixing 1 mm"ckM.S. sheet door with frame of 40x40x6 mm angle iron and 3 mm M.S. gusset plates at the junctions and comers, all necessary fittings complete, including applying a priming coat of approved steel primer.	15.84	Sqm		
	Using M.S. angles 40x40x6 mm for diagonal braces				
13	Providing, fitting and fixing steel windows (including ventilators) of standard rolled steel sections as per relevant I.S. Code, ..... complete including providing 12x12 mm square bars duly welded to steel frame at not more than 12 cm c/c applying a priming coat of red-lead paint etc. complete as per drawing	3.60	Sqm		

14	Providing & fixing glass panes with putty and glazing clips in steel doors, windows, clerestory windows, all complete wit	5.60	Sqm		
	4.0 mm thick glass panes				
15	20 mm cement plaster of mix:	36.30	Sqm		
	1 :4 (1 cement: 4 fine sand)				
16	Cement mortar 1 :4 (1 cement: 4 fine sand).	10.41	Cum		
17	Painting with synthetic enamel paint of approved brand and manufacture to give an even shade:	59.26	Sqm		
18	Wall painting with acrylic emulsion pain of approved brand and manufacture to give an even shade	26.10	Sqm		
	New work (two or more coats)				
19	Providing and fixing lsl marked M.S. pressed butt hinges bright finished with necessary screws etc. complete:	9	Each		
	125x65x2.12 mm				
20	Providing and fixing lsl marked oxidised M.S. sliding door bolts with nuts and screws etc. complete:	3	Each		
	300x16 mm				
21	Providing and fixing lsl marked oxidised M.S. tower bolt black finish, (Barrel type) with necessary screws etc. complete	3	Each		
	200x10 mm				
22	Providing and fixing chlorinated polyvjnyl chloride (CPVC) pipes, having thermal stability for hot & cold water supply, including all CPVC plain & brass threaded fittings, including fixing the pipe with clamps at 1.00 in spacing. This includes jointing Of pipes & fittings with one step CPVC solvent cement and testing of joints complete as per direction of Engineer in Charge.	78.00	Rm		
	Internal work - Exposed on wall				
	25 mm nominal outer diameter pipes				
	50 mm nominal outer pipes	70.00	Rm		

23	Providing and fixing PTMT bib cock of approved quality and colour.	2	Each		
	15 mm nominal bore, 90 mm long, weighing not less than 93 gins (with nozzle)				
24	Providing and fixing wash basin with C.I. brackets, 15 mm C.P. brass pillar taps, 32 mm C.P. brass waste of standard pattern. including painting of fittings and brackcts, cutting and making good the walls wherever require	2	Each		
	Stainless Steel AISI-304(18/8) Pound basin 405x355 mm with single 15 mm C.P. brass pillar tap				
	Total Quoted Amount= Rs.				

Signature of Contractors/Bidders



## DRAWINGS

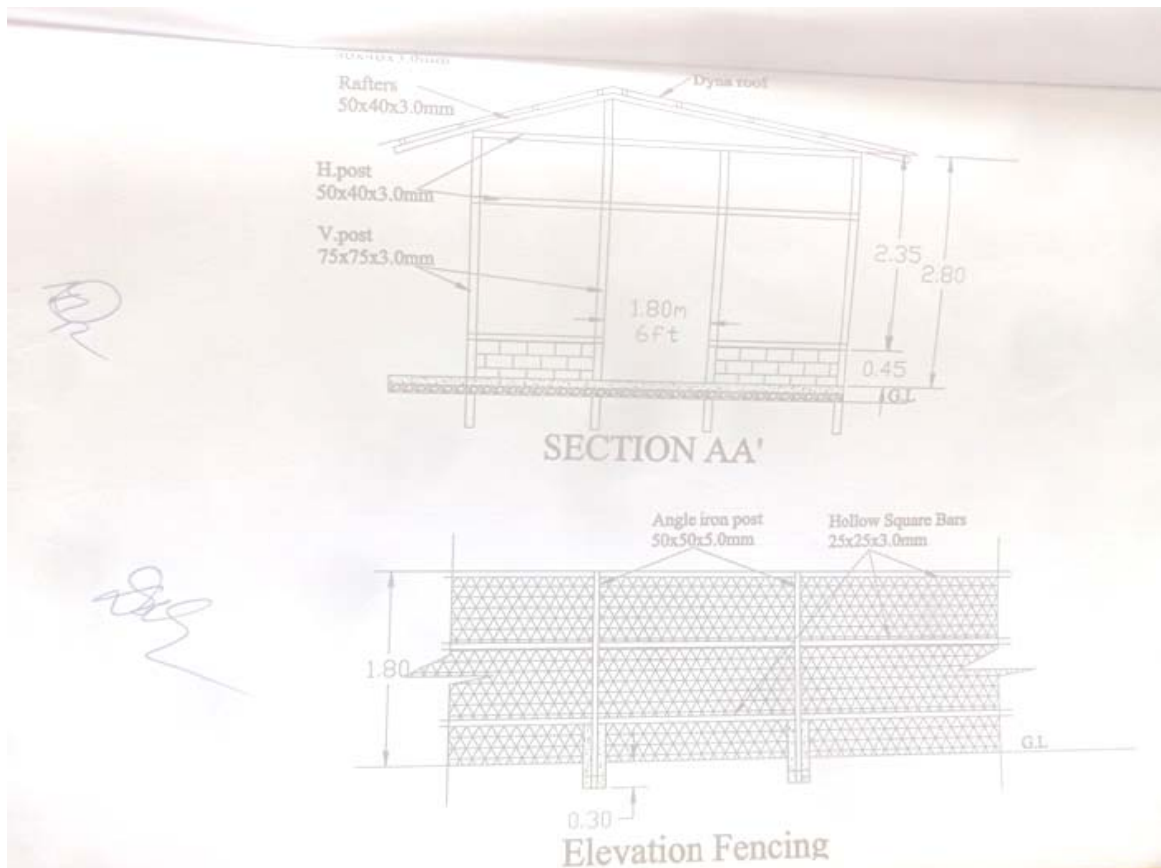
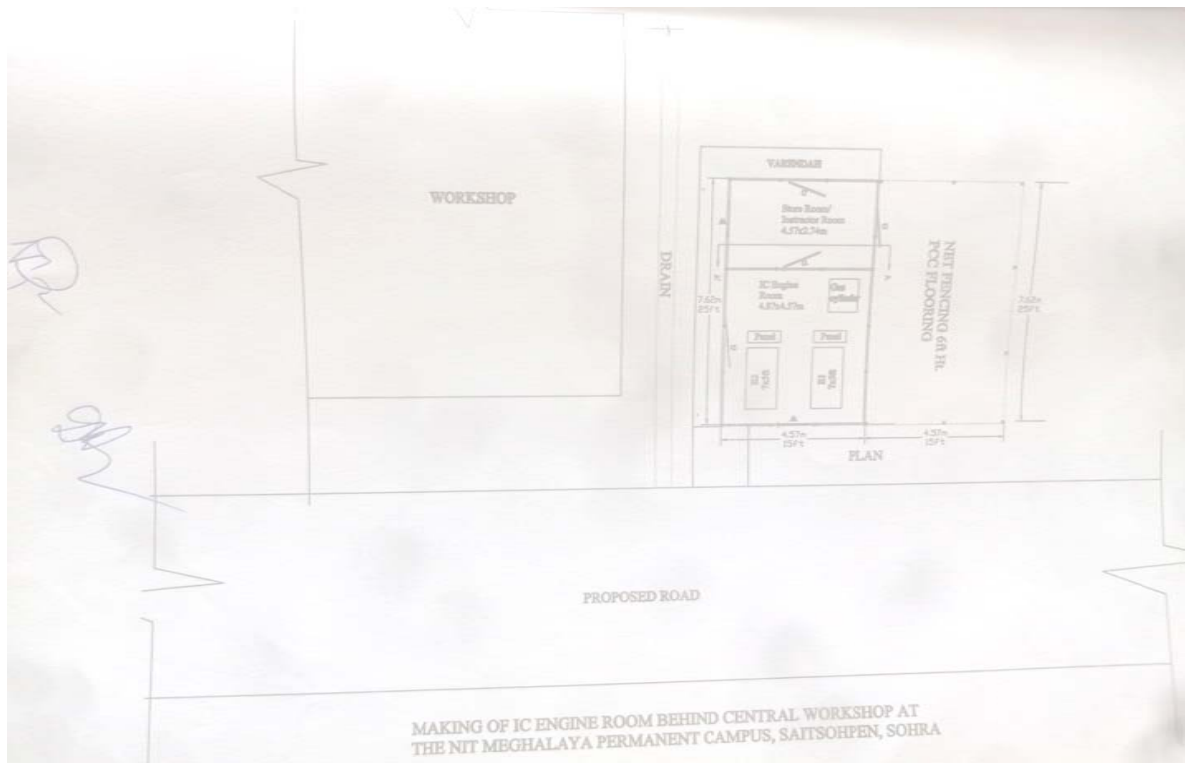

## UNDERTAKING IN FORM - A

*I do hereby declare that the works will be done by me and I also hereby declare that the signature in all pages of the tender papers is signed by me.*

*Further, I declare that I have gone through the various clauses of the contract document and I am fully conversant with all the clauses contained therein and agree to abide by the same.*

*Full Name of contractor* : \_\_\_\_\_

: \_\_\_\_\_

*Full Address (Present)* : \_\_\_\_\_

: \_\_\_\_\_

: \_\_\_\_\_

*Full Address (Permanent):* \_\_\_\_\_

: \_\_\_\_\_

: \_\_\_\_\_

*Contact Number* : \_\_\_\_\_

*E-mail ID* : \_\_\_\_\_

*Registration No.* : \_\_\_\_\_

**(Signature of the bidder's)**